



IMPORTANT!

Read these instructions or damage to your product may result.

ASSEMBLY

1. Insert the titanium wire screen into the glass chamber until it is held in place by the two detents at the bottom of the chamber.



2. Install the glass vaporizer chamber into a mouth piece with a 14mm female joint.

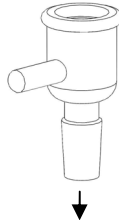

OPERATION

1. Place the heater head into the heater stand and pre-heat the heater to the desired temperature.

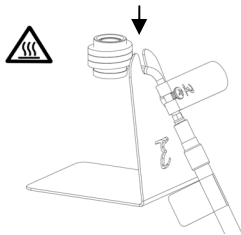

NEVER heat-up while on the glass vaporizer chamber or the chamber may break from expansion.

2. Put dry herb material into the chamber. Use a small amount; enough to cover the screen for best results.

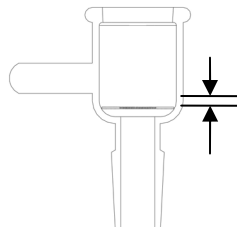

CAUTION chamber may be hot.

3. Install heater onto vaporizer chamber and begin drawing a constant flow of air through the chamber.

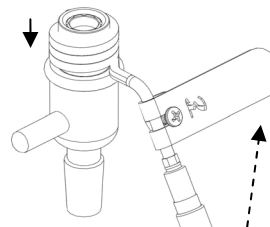

CAUTION Grip the heater by the handle provided to prevent strain on the power cable.

4. When air flow is stopped, remove the heater from the vaporizer chamber and return to the heater stand.

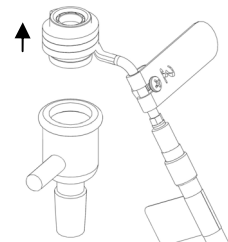

CAUTION Use caution not to put undue stress on the chamber when separating the heater head.

CLEANING

1. Grip the chamber by the handle and empty the spent contents.

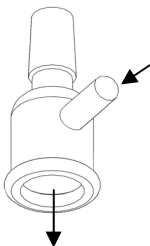

2. If desired, heat the chamber by drawing air through a pre-heated heater. This assists in loosening material.

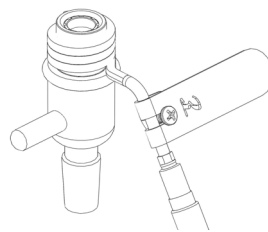

CAUTION chamber may be hot.

3. Fill the chamber with isopropyl alcohol and scrub with a cotton swab. Rinse with alcohol followed by hot water.



4. If desired, dry water from the chamber and screen by drawing air through a pre-heater heater.

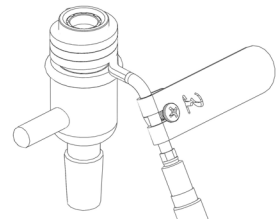

CAUTION chamber may be hot.

P/N: XMA5-7